

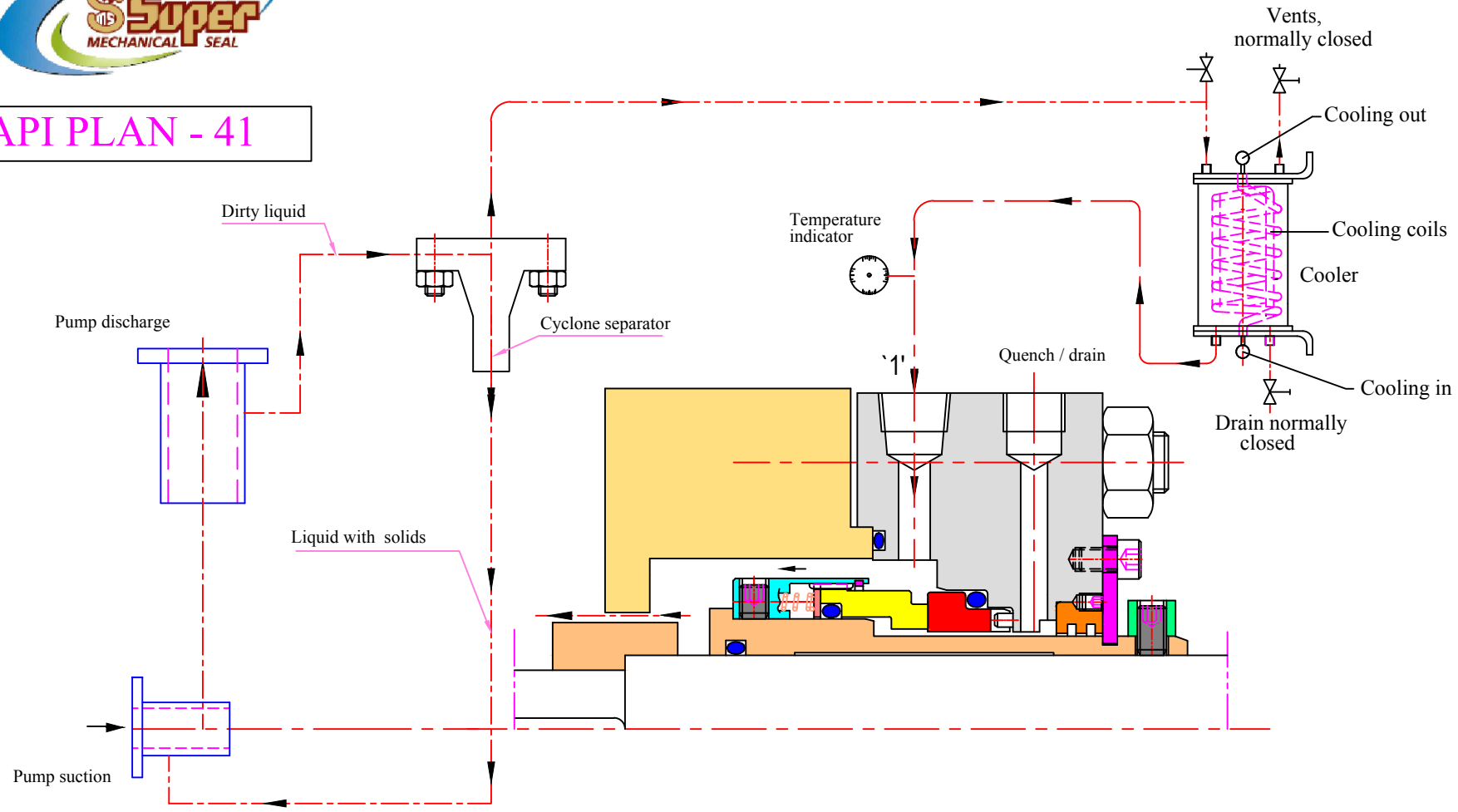

API PLAN - 41



- Recirculating from pump discharge through a cyclone separator and heatexchanger and back to seal chamber.
- The solids are delivered to the pump suction from cyclone separator.
- Connection `1' for flushing inlet.
- High temperature service, typically less than 350°F (177°C).
- Dirty or contaminated fluids, water with sand or pipe slag.
- Non-polymerizing fluids.